

EN010092 - Thurrock Flexible Generation Plant – Accompanied Site Inspection Request

On behalf of Thurrock District Scout Council, I would like to request the Examiners to undertake an Accompanied Site Inspection (ASI) of Condovers Scout Activity Centre, Church Road, East Tilbury. RM18 8QX

Condovers Scout Activity Centre (Condovers) is approximately 3.5 acres and is located on the south side of Church Road between Cooper Shaw Road and Low Street Lane. Condovers is used all year round by members of Thurrock Scouts, most of the activities at Condovers take place outdoors and all people staying at the site use tents as sleeping accommodation. Our peak use of the site is weekends (Easter to October) and weekdays (late afternoon/evenings) May to August.

Condovers Scout Activity Centre has been operating on this site since 1948 and has been detailed in the applicant's documentation as Havers Lodge, one of the buildings on the site.

Our main concerns with the proposals are:

- Additional HGV traffic on Church Road during construction, a very narrow country lane, going to the Zone C corridor for permanent access road, gas pipeline route and construction laydown.
- The environmental impact, noise, and air quality on Condovers, during the construction of the gas pipeline and permanent access road in zone C, parallel to the railway line.
- The environmental impact, noise, and air quality during operation of the generation plant, on Condovers.
- The cumulative effect of HGV traffic on Church Road, during construction, if it overlapped with the proposed construction of the Lower Thames Crossing (LTC).

Issues to be observed:

- The proposed pipeline construction site - looking south from the southern boundary of the Condovers site, which sits approximately 100 to 170 metres from the railway line and the proposed gas pipeline construction site.
- Proposed main development site - looking in a south westerly direction, the main development site is approximately 500 metres from the boundary of our site.
- From the main entrance, observe the width of Church road with regard HGV's passing.

People to attend:

Providing Government guidelines permit, then I anticipate that the following people will be available to attend:

1. Geoffrey Harris, Chair of Thurrock District Scout Council
2. Tim Webb, Group Scout Leader
3. Stewart Abbott, Project Leader

Access to the site:

The site is secure and does not have any public access. Access to the site can be arranged by Stewart Abbott via his email [REDACTED] or on his mobile [REDACTED]

I have attached a plan showing our activity centre in relation your published development zones.

CONDONORS SLOW ACTIVITY CENTRE

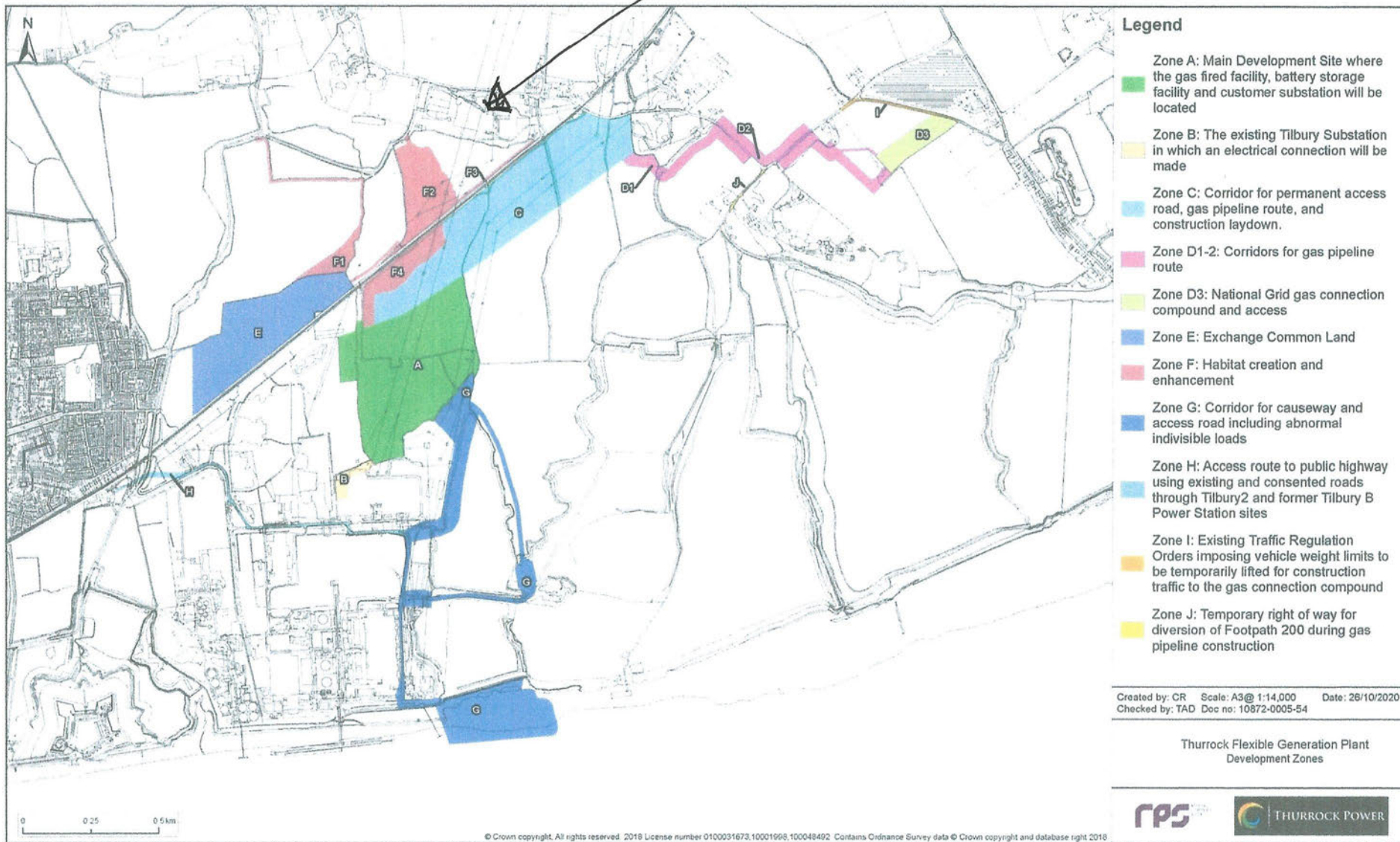

Figure 1.51.6: Development zones.